

ILLUSTRATED PARTS BREAKDOWN

CL8 UNIT ASSEMBLY

HOW TO USE THE IPB

GENERAL

This IPB is compiled following the organization and nomenclature of the engineering drawing structure.

MAJOR ASSEMBLY LOCATOR

The Major Assembly Locator (first illustration) is an index that provides a description and a figure reference for all illustrations used in this manual.

INDENTED PARTS LIST

This manual identifies each assembly being broken down (figure reference callout), and all parts of that assembly. Further breakdown of an assembly is shown by an asterisk (*) preceding the item callouts in the Description Column. The number of asterisks preceding an item is used to denote the subordination of that item with respect to the Major Assembly. A single asterisk preceding an item description indicates that the item is part of the major assembly being illustrated. Items that are subordinate to single asterisks items, are denoted by two asterisks (**) and immediately follow the related single asterisk item. Additional asterisks are used, as required, to denote further subordination. This system of part identification, provides a means for the user to identify the next higher assembly item and make alternate selections for parts when the required replacement part or assembly is not immediately available.

COLUMN CALLOUT DESCRIPTION

Figure & Item — Indicates the figure number and item number of each part.

Description — Lists the name of the part and pertinent specifications (when required). Asterisks preceding the description denote the subordination of the part to the next higher assembly.

DEC Part No. — Lists the DEC part ordering number. A blank in this column indicates a DEC part number was not assigned at the time of publication.

ECO Cut-In — The notation at the top of this column indicates the ECO level of the system (option), at which the IPB was initially prepared. Subsequent ECO level designations, that modify existing parts or add new parts to the device, are inserted in the ECO Cut-In column next to the part that is added or modified. A bracket ([]) preceding the item description is used to indicate the parts affected by ECO's.

Vendor Code/Part No. — Indicates vendor parts that are not stocked by DEC. Refer to the Field Service Spares Catalog (vendor part number to DEC part number) for the vendor code cross-reference.

Used On Code — Letters in this column correspond to the variation codes assigned in Figure 1. Parts with an Alpha notation(s) are used only in those option variations. A blank indicates that the part is used on all option variations.

Ref Fig No. — A cross reference between illustrations. For each Major Assembly, the number in this column denotes the figure of the next higher assembly. For all subassemblies, the number in this column denotes the figure showing additional detailed breakdown.

SYMBOL USAGE

Hardware Designators — Alpha designators for screws (S), washers (W), nuts (N), and retaining rings (R) are inserted after the item number callouts on the illustration when stacked item numbers are used.

Attaching Hardware — The @ symbol is inserted before any part that is used as attaching hardware. Attaching hardware is denoted as those parts that are not an integral part of the referenced assembly.

(NFR) Not Field Repairable — The (NFR) symbol is inserted after any assembly that is not to be field dismantled.

Other Symbols — Any other symbols that are required for kits, accessories, etc., will be explained and appear as part of the item description.

REVISION HISTORY

PRINTING	ECO LEVEL	DATE	PAGES AFFECTED
1st Printing	CL8 70-10962 70-10961 70-11043 70-11897 BC05M	00003-00003 00003-00003 00001-00001 00001-00001 00001-00001 00001-00001	5-21-76 N/A

Copyright © 1976 by Digital Equipment Corporation

DEC reserves the right, without notice, to make substitutions and modifications in the specifications of products documented in this manual and further reserves the right to withdraw any of these products from the market without notice.

DEC is not responsible for errors which may appear in the technical description (including illustrations and photographs) of the products covered by this manual.

None of the descriptions contained in this manual imply the granting of any license whatsoever to make, use or sell equipment constructed in accordance therewith.

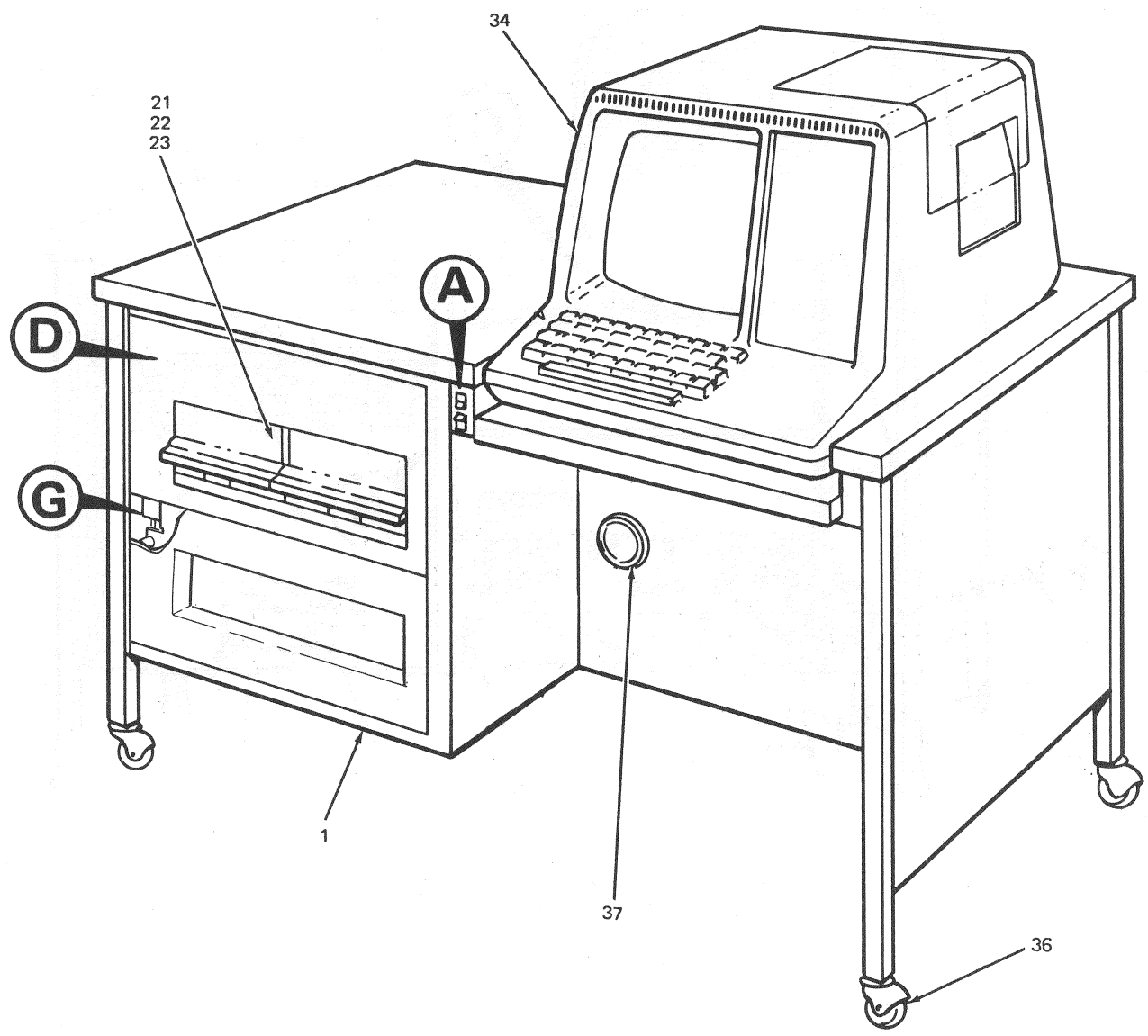

CL8-01

Figure 1. CL8 Unit Assembly (Sheet 1 of 3)

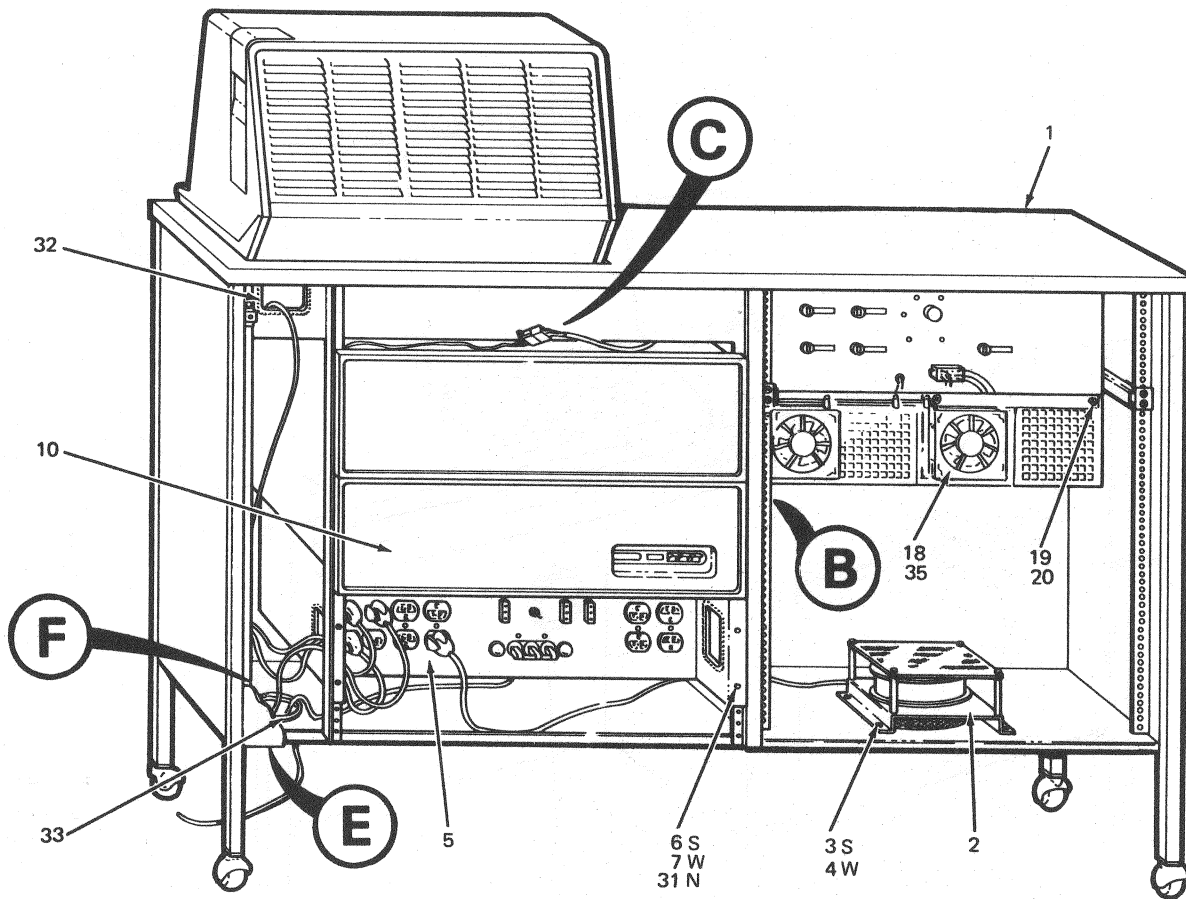

CL8-01

Figure 1. CL8 Unit Assembly (Sheet 2 of 3)

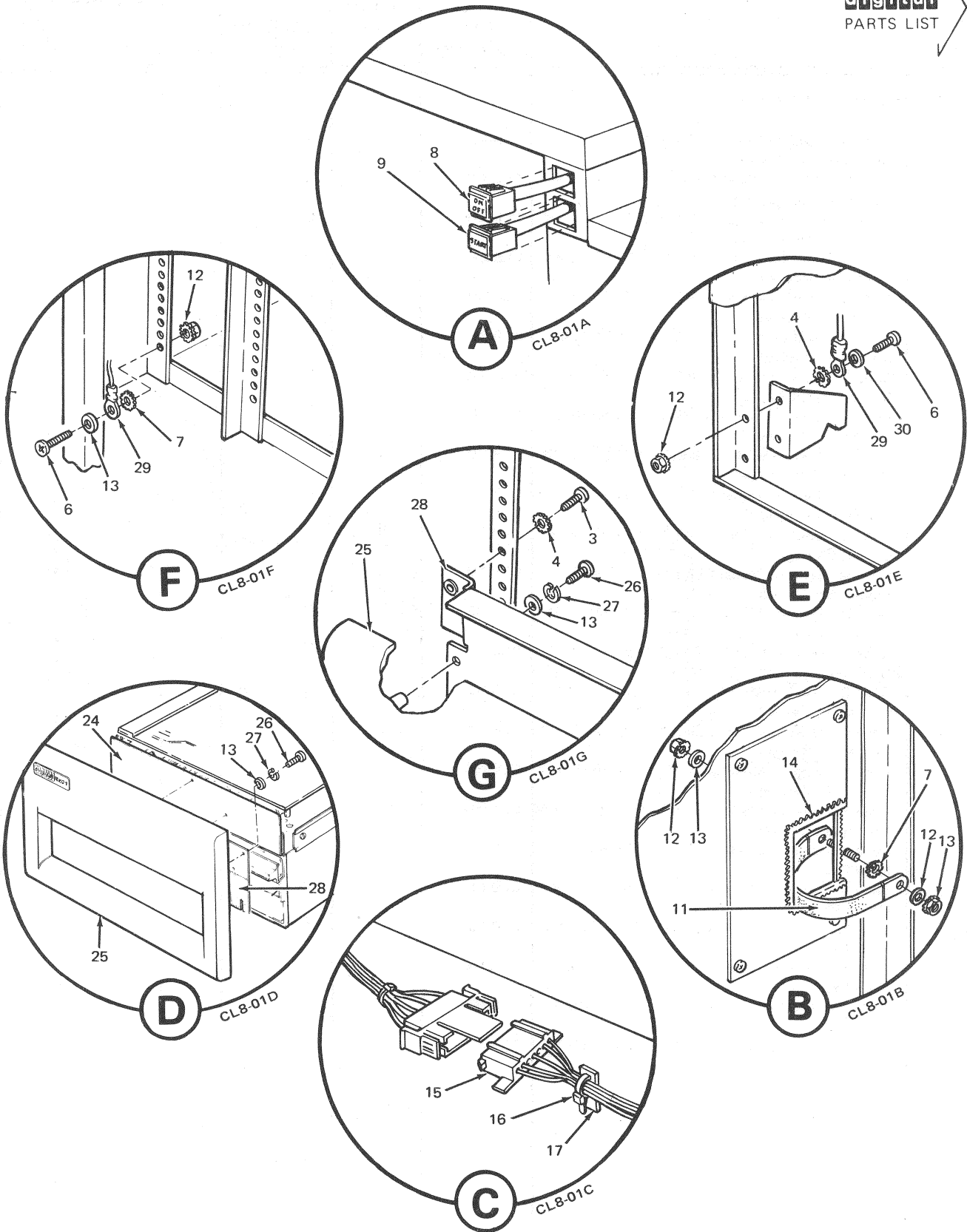

Figure 1. CL8 Unit Assembly (Sheet 3 of 3)

FIG & ITEM NO.	DESCRIPTION	DEC PART NO.	ECO CUT-IN CL8 00003	USED ON CODE	VENDOR		REF FIG NO.
					CODE	PART NO.	
1-	CL8 UNIT ASSEMBLY						
	Code A - Used on Model CL8-AA, 115V 60 Hz 8K No Copier, No Keypad	CL8-AA		A			
	Code B - Used on Model CL8-AC, 115V 50 Hz 8K No Copier, No Keypad	CL8-AC		B			
	Code C - Used on Model CL8-AD, 230V 50 Hz 8K No Copier, No Keypad	CL8-AD		C			
	Code D - Used on Model CL8-CE, 115V 60 Hz 8K No Copier, Keypad	CL8-CE		D			
	Code E - Used on Model CL8-CH, 115V 50 Hz 8K No Copier, Keypad	CL8-CH		E			
	Code F - Used on Model CL8-CJ, 230V 50 Hz 8K No Copier, Keypad	CL8-CJ		F			
	Code G - Used on Model CL8-EA, 115V 60 Hz 16K No Copier, No Keypad	CL8-EA		G			
	Code H - Used on Model CL8-EC, 115V 50 Hz 16K No Copier, No Keypad	CL8-EC		H			
	Code J - Used on Model CL8-ED, 230V 50 Hz 16K No Copier, No Keypad	CL8-ED		J			
	Code K - Used on Model CL8-FA, 115V 60 Hz 16K Copier, No Keypad	CL8-FA		K			
	Code L - Used on Model CL8-FC, 115V 50 Hz 16K Copier, No Keypad	CL8-FC		L			
	Code M - Used on Model CL8-FD, 230V 50 Hz 16K Copier, No Keypad	CL8-FD		M			
	Code N - Used on Model CL8-HE, 115V 60 Hz 16K No Copier, Keypad	CL8-HE		N			
	Code P - Used on Model CL8-HH, 115V 50 Hz 16K No Copier, Keypad	CL8-HH		P			
	Code Q - Used on Model CL8-HJ, 230V 50 Hz 16K No Copier, Keypad	CL8-HJ		Q			
	Code R - Used on Model CL8-HA, 115V 60 Hz 16K No Copier, Keypad	CL8-HA		R			
	Code S - Used on Model CL8-HC, 115V 50 Hz 16K No Copier, Keypad	CL8-HC		S			
	Code T - Used on Model CL8-HD, 230V 50 Hz 16K No Copier, Keypad	CL8-HD		T			
	Code U - Used on Model CL8-LE, 115V 60 Hz 8K No VT50	CL8-LE		U			
	Code V - Used on Model CL8-LH, 115V 50 Hz 8K No VT50	CL8-LH		V			
	Code W - Used on Model CL8-LJ, 230V 50 Hz 8K No VT50	CL8-LJ		W			
	Code X - Used on Model CL8-ME, 115V 60 Hz 16K No VT50	CL8-ME		X			
	Code Y - Used on Model CL8-MH, 115V 50Hz 16K No VT50	CL8-MH		Y			
	Code Z - Used on Model CL8-MJ, 230V 50 Hz 16K No VT50	CL8-MJ		Z			

FIG & ITEM NO.	DESCRIPTION	DEC PART NO.	ECO CUT-IN CL8 00003	USED ON CODE	VENDOR		REF FIG NO.
					CODE	PART NO.	
1-							
1	*DESK ASSEMBLY (WALNUT TOP)	H982-W		DEFNPQ UVWXYZ			
	*DESK ASSEMBLY (TEAK TOP)	H982-T		ABCGHJ KLMRST			
2	*FAN ASSEMBLY (115V, 50/60 Hz)	70-11043-00		ABDEGH KLNPRS UVXY			4
	*FAN ASSEMBLY (230V, 50 Hz)	70-11043-01		CFJMQTWZ			4
3	*Screw Phi Pan Hd No. 8-32 x .38	90-06037-01					
4	*Washer, External Tooth Lock No. 8	90-08072-00					
5	*861 POWER CONTROLLER (230V)	861-B		CFJMQTWZ	See IPB Manual EK-861-IP		
	*861 POWER CONTROLLER (115V)	861-F		ABDEGHUV KLNPRSXY	See IPB Manual EK-861-IP		
6	*Screw, Phi Truss Hd No. 10-32 x .50	90-06565-00					
7	*Wash, External Tooth Lock No. 10	90-07651-00					
8	*POWER CABLE ASSEMBLY	70-10961-00					3
9	*CONTROL CABLE ASSEMBLY	70-10962-00					2
10	*8A500 COMPUTER ASSEMBLY 8K 60 Hz	8A500-LM		ADU	See IPB Manual EK-8A500-IP		
	*8A500 COMPUTER ASSEMBLY 8K 50 Hz	8A500-LN		BCEFW	See IPB Manual EK-8A500-IP		
	*8A500 COMPUTER ASSEMBLY 16K 60 Hz	8A500-LP		GKNRX	See IPB Manual EK-8A500-IP		
	*8A500 COMPUTER ASSEMBLY 16K 50 Hz	8A500-LR		HJLMP QSTYZ	See IPB Manual EK-8A500-IP		
11	*Ground Strap	90-06990-00					
12	*Nut, Keps No. 10-32	90-06565-00					
13	*Washer, Flat No. 10	90-06676-00					
14	*Grommet	90-08209-00					
15	*CABLE ASSEMBLY (KL8E)	70-08360-00					6
16	*Cable Tie	90-07880-00					
17	*Cable Tie Mount, Adh Back	90-08264-00					
18	*FAN ASSEMBLY (115V 60HZ)	70-11897-00		ADGKNRUX			5
19	*Screw, Phi Pan Hd No. 8-32 x .25	90-06035-01					
20	*Wash, Internal Tooth Lock No. 8	90-06634-00					
21	*RX8 FLOPPY DISK ASSEMBLY 90V-132V 60 Hz	RX8-DA		ADGKNRUX			
	**RX8-E Omnibus Interface	M8357-00					
	**RX01 Dual Floppy Disk Assembly	RX01-DA		ADGKNRUX	See IPB Manual EK-RX01-IP		
22	*RX8 FLOPPY DISK ASSEMBLY 90V-132V 50 Hz	RX8-DC		BEHLPSVY			
	**RX8-E Omnibus Interface	M8357-00					
	**RX01 Dual Floppy Disk Assembly	RX01-DC		BEHLPSVY	See IPB Manual EK-RX01-IP		
23	*RX8 FLOPPY DISK ASSEMBLY 180V-264V 50 Hz	RX8-DD		CFJMQTWZ			
	**RX8-E Omnibus Interface	M8357-00					
	**RX01 Dual Floppy Disk Assembly	RX01-DD		CFJMQTWZ	See IPB Manual EK-RX01-IP		
24	*Panel, Front Dual Drive	74-12853-00					
25	*Bezel, RX01	74-12664-00		ABCGHJ KLMRST DEFNPQ UVWXYZ			
	*Bezel, RX01	74-12664-03					
26	*Screw, Phi Pan Hd No. 10-24 x .50	90-08012-01					
27	*Washer, Spring Lock No. 10	90-07906-00					

FIG & ITEM NO.	DESCRIPTION	DEC PART NO.	ECO CUT-IN CL8 00003	USED ON CODE	VENDOR		REF FIG NO.
					CODE	PART NO.	
1-							
28	*Bracket, Bezel	74-13844-01		DEFNPO UVWXYZ ABCGHJ KLMRST			
	*Bracket, Bezel	74-13844-00					
29	*Ground Wire	70-11168-00					
30	*Washer, Flat No. 8	90-06660-00					
31	*Nut, Speed No. 10-32	90-07786-00					
32	*Grommet 7.75 Long	90-08209-00					
33	*Grommet 7.85 Long	90-08209-00					
34	*VT50 UNIT ASSEMBLY	VT50-AA		AG CJ BH K M L DNR FQT EPS BCEFJH LMPOST VWYZ			
	*VT50 UNIT ASSEMBLY	VT50-AB					
	*VT50 UNIT ASSEMBLY	VT50-AC					
	*VT50 UNIT ASSEMBLY (COPIER)	VT50-BA					
	*VT50 UNIT ASSEMBLY (COPIER)	VT50-BB					
	*VT50 UNIT ASSEMBLY (COPIER)	VT50-BC					
	*VT50 UNIT ASSEMBLY (KEY PAD)	VT50-HA					
	*VT50 UNIT ASSEMBLY (KEY PAD)	VT50-HB					
	*VT50 UNIT ASSEMBLY (KEY PAD)	VT50-HC					
35	*FAN ASSEMBLY (230V 50HZ)	70-11897-01					
36	*Casters, 2" Ball	34-12383-07					
37	*Access Cover	34-12383-10					
	DECALS and STICKERS (Not Shown)						
	†Decal, CAUTION: LEAKAGE	53-10919-00					
	†Sticker, Serial No.	36-12450-00					
	†Sticker, UL	36-12449-00					
	Special Parts (Not Shown)						
	†Bootstrap ROM No. 1	23-156A2-00	See Note				
	†Bootstrap ROM No. 2	23-157A2-00	See Note				
	Note: ROM No. 1 and 2 are located on M8317 (KM8-AA) See IPB Manual EK-8A500-IP						

FIG & ITEM NO.	DESCRIPTION	DEC PART NO.	ECO CUT-IN 70-10962 00003	USED ON CODE	VENDOR		REF FIG NO.
					CODE	PART NO.	
2-	CONTROL CABLE ASSEMBLY	70-10962-00					1
1	*Connector, (P1) Termination Housing, Berg	12-10918-15					
2	*Terminals, Crimp (P1)	12-10089-06					
3	*Switch, Rocker (DPDT)	12-12611-01					
4	*Bezel	12-12611-04					
5	*Cable	90-07706-00					
6	*Rocker, White (Reworked)	74-13645-00					

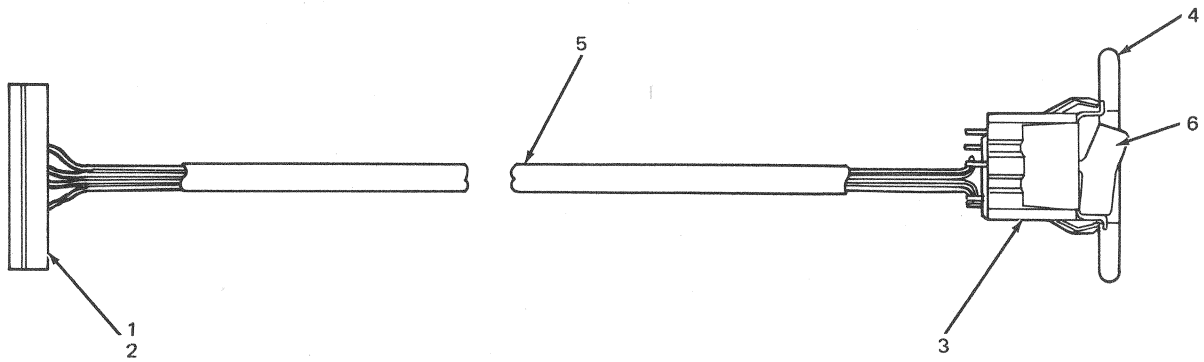

CL8-02

Figure 2. Control Cable Assembly

FIG & ITEM NO.	DESCRIPTION	DEC PART NO.	ECO CUT-IN 70-10961 00001	USED ON CODE	VENDOR		REF FIG NO.
					CODE	PART NO.	
3-	POWER CABLE ASSEMBLY	70-10961-00					1
1	*Connector, (P1) Panel Mount, 3 Pin Mate-N-Lok	12-09351-03					
2	*Terminal, (P1) Pin Contact	12-09378-03					
3	*Switch	12-12611-00					
4	*Bezel	12-12611-04					
5	*Rocker, Red (Reworked)	74-13646-00					
6	*Wire	91-07706-00					

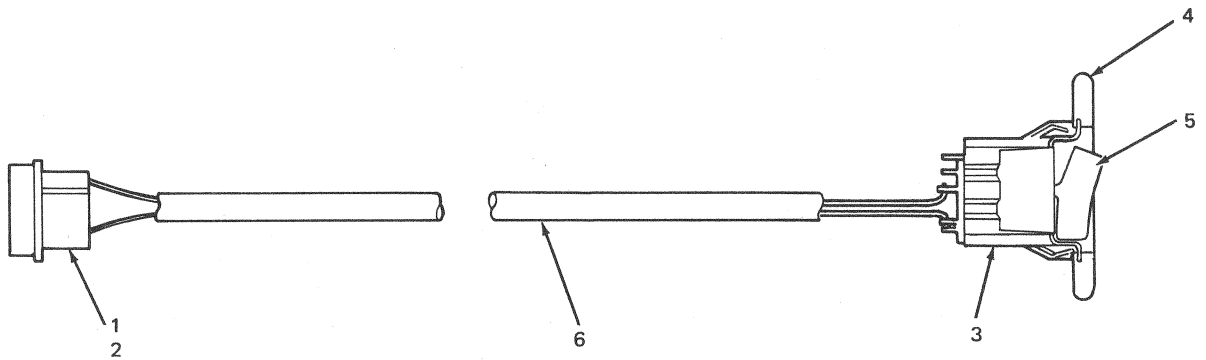

CL8-03

Figure 3. Power Cable Assembly

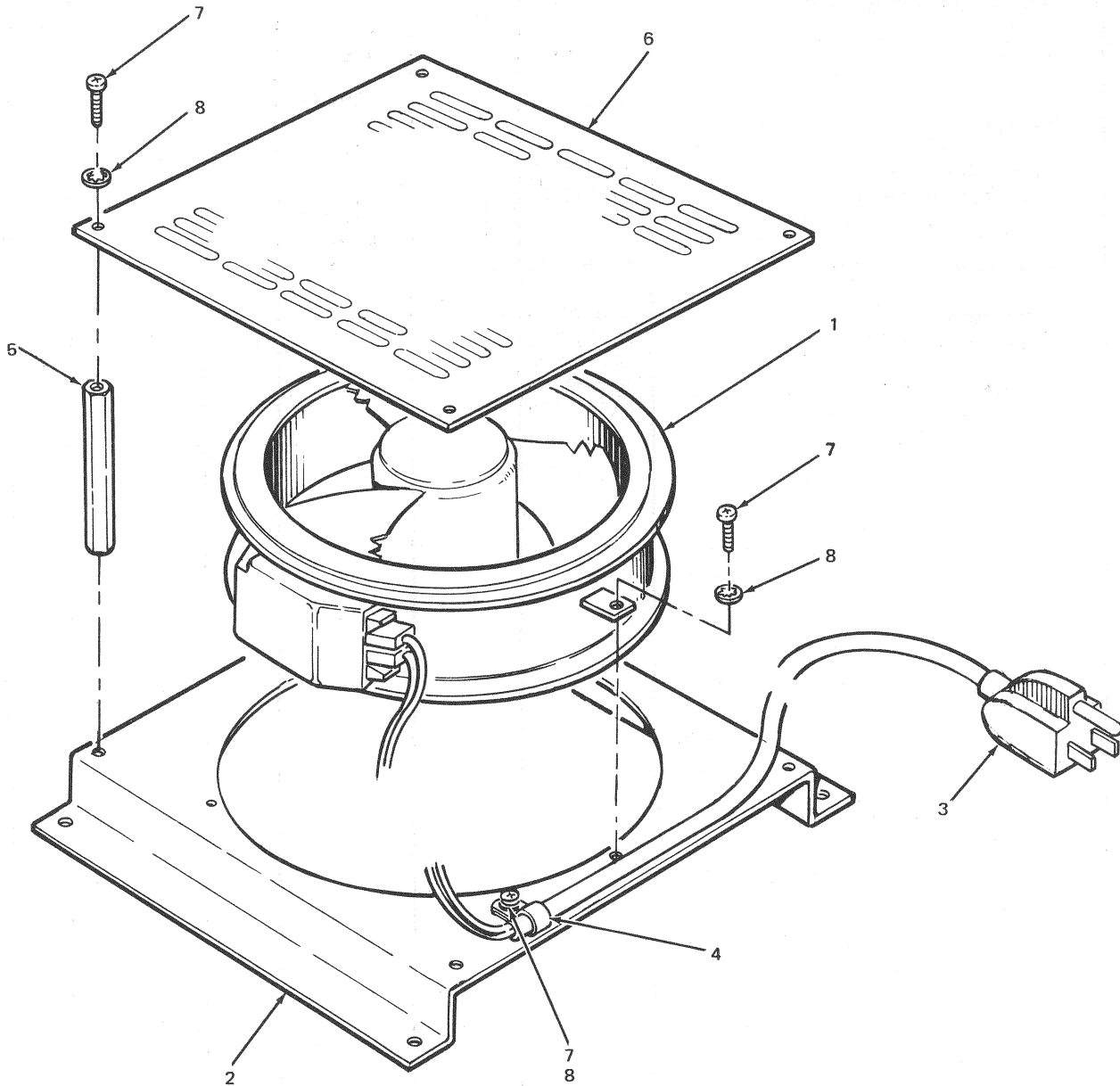
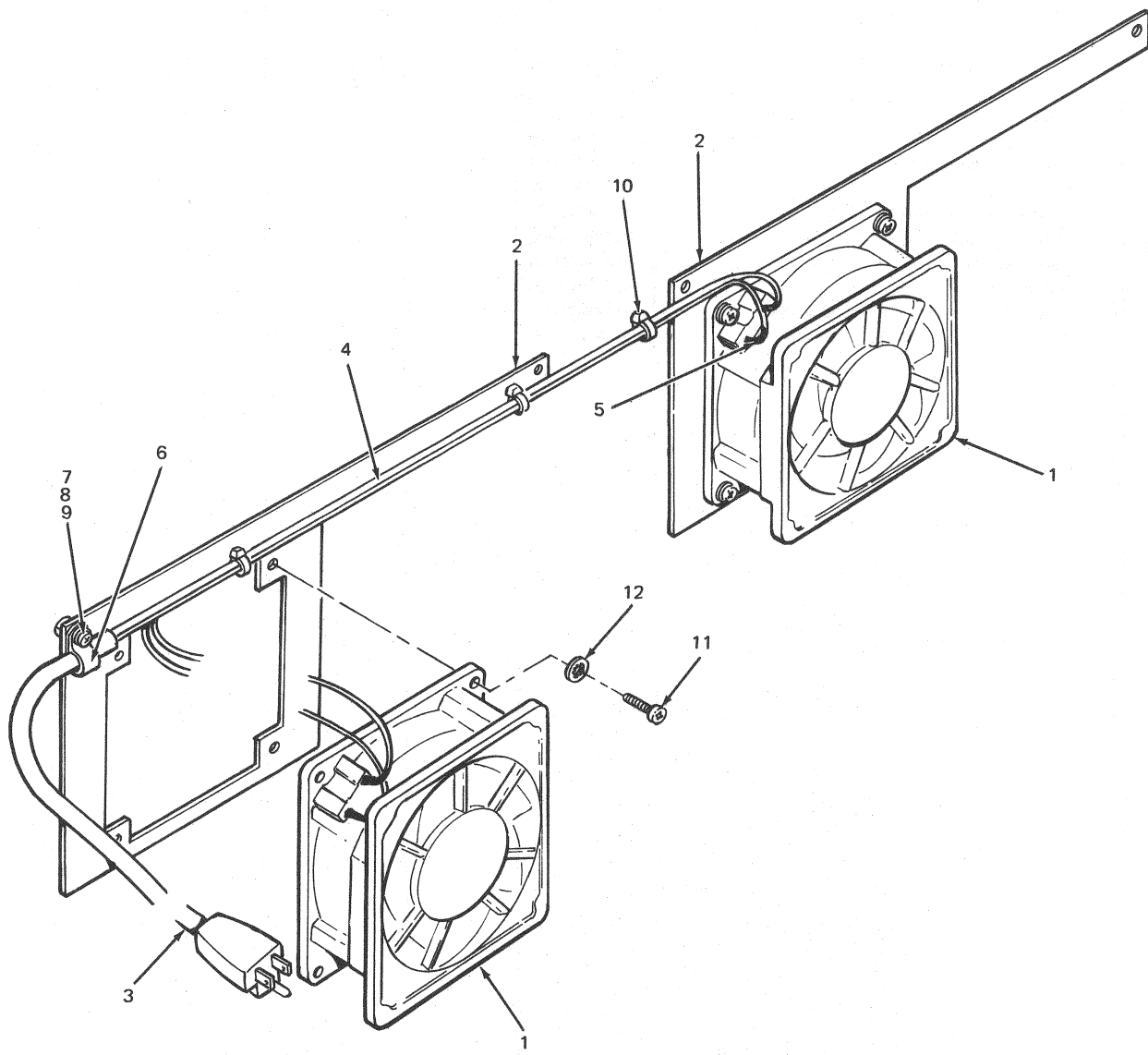

Figure 4. Fan Assembly

CL8-04

FIG & ITEM NO.	DESCRIPTION	DEC PART NO.	A ECO CUT-IN 70-11043 00001	USED ON CODE	VENDOR		REF FIG NO.
					CODE	PART NO.	
4-	FAN ASSEMBLY (115V, 50/60 Hz)	70-11043-00		ABDEGH KLNPRS UVXY			1
	FAN ASSEMBLY (230V, 50 Hz)	70-11043-01		CFJMQ TWZ			1
1	*Fan (115V)	12-11240-00		ABDEG HKLNP RSUVXY			
	*Fan (230V)	12-11240-01		CFJMQ TWZ			
2	*Bracket, Fan	74-13726-00					
3	*Power Cord, Rework (115V)	70-11064-00		ABDEG HKLNPR SUVXY			
	*Power Cord, Rework (230V)	70-11064-01		CFJMQ TWZ			
4	*Cable Clamp	90-07082-00					
5	*Spacer, No. 6-32 x 2.5	90-06870-00					
6	*Screen, Fan	74-13727-00					
7	*Screw, Phi Pan Hd, No. 6-32 x .31	90-06021-01					
8	*Washer, Internal Tooth Lock, No. 6	90-06633-00					



CL8-05

Figure 5. Fan Assembly

FIG & ITEM NO.	DESCRIPTION	DEC PART NO.	A ECO CUT-IN 70-11897 00001	USED ON CODE	VENDOR		REF FIG NO.
					CODE	PART NO.	
5-	FAN ASSEMBLY (115V, 50/60 Hz)	70-11897-00		ABDEGH KLNPRS UVXY CFJMQ TWZ			1
	FAN ASSEMBLY (230V, 50 Hz)	70-11897-01					1
1	*Fan	12-10719-00					
2	*Bracket, Fan	74-14957-00					
3	*Power Cord, Rework (115V)	74-14969-00		ABDEGH KLNPRS UVXY CFJMQ TWZ			
	*Power Cord, Rework (230V)	74-14969-01					
4	*Wire, 18 AWG, Stranded (Black)	91-07360-00					
	*Wire, 18 AWG, Stranded (White)	91-07360-99					
5	*Tubing, Heat Shrink	91-07255-02					
6	*Clamp, Cable	90-07082-00					
7	*Screw, Phl. Pan Hd. No. 8-32 x .38	90-06037-01					
8	*Washer, Internal Tooth Lock, No. 8	90-06634-00					
9	*Nut, Keps No. 8-32	90-06563-00					
10	*Cable Tie	90-07031-00					
11	*Screw, Phl. Pan Hd. No. 6-32 x .38	90-06022-01					
12	*Washer, Internal Tooth Lock, No. 6	90-06633-00					

FIG & ITEM NO.	DESCRIPTION	DEC PART NO.	ECO CUT-IN BC05M 00001	USED ON CODE	VENDOR		REF FIG NO.
					CODE	PART NO.	
6-	CABLE ASSEMBLY (KL8E) (27 inch) CABLE ASSEMBLY (KL8E) (48 inch)	70-08360-00 70-08360-01					1
1	*Connector, (P1) Socket Housing, 8 Pin Mate-N-Lok	12-09340-00					
2	*Terminal, Socket Contact (P1)	12-09379-03					
3	*Connector, (P2) Termination Housing, Berg	12-10918-15					
4	*Terminal, Socket Crimp (P2)	12-10089-07					
5	*Cable, Belden, 3 Pair Shield No. 8777	91-07723-00					
6	*Strain Relief	12-11166-00					
							DEC

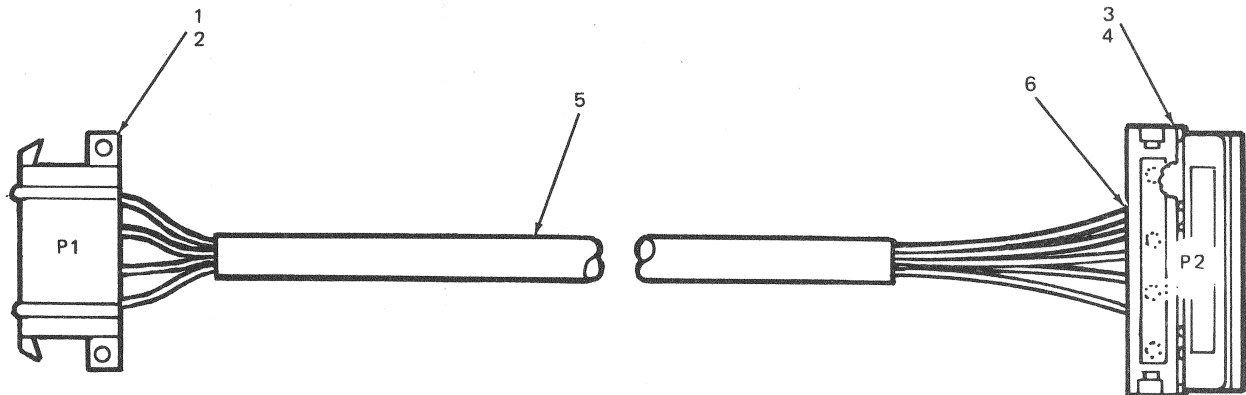

11/055-03

Figure 6. Cable Assembly (KL8E)

