

REVISIONS				
LTR	DESCRIPTION	DATE	APPROVED	
U1 U4 U18	74LS00	U39 U40 U41	75189 75188 75452	
U2 U3	74LS32 74LS02	C7, C8, C11, C12, C14, C15, C16, C18, C19, C20, C21, C22, C23, C24, C27, C28, C29, C30, C31 C32, C33, C34	.1 uF	
U5 U29	74LS08	C6, C9	2.2 uF	
U6	74LS11	C10	4.7 uF	
U7 U8	8111A-4	CR1	IN4148	
U9	FIRMWARE PROM SOCKET	CR2 CR5 CR3 CR4	IN270 IN4002	
U10 U32-U36	8T97	Y1	6MHZ	
U11 U17 U28 U30	74LS04	R9 - R16 R18 - R20 R25, R26 R33 - R35 R50	1K 1/4w	
U12 U13 U14	S1 S2 74LS05	R17, R23, R24 R28 - R32, R38	10K 1/4w	
U15 U16	74LS195	R1 - R8, R21, R22 R36, R37, R39	4.7 1/4w	
U19 U20	74LS155 8085	R44 - R48		
U21-U23	8212	R40	750 1/4w	
U24	8253-2	R41	620 1/4w	
U25 U26	8251A 74LS109	R42 R43	150 1/4w	
U27	74LS74			
U31	3622			
U37	74LS367			
U38	74S288			

TOLERANCES UNLESS OTHERWISE SPECIFIED				
FRACTIONS	DEC.	ANGLES		
±	±	±		
APPROVALS	DATE	<b>MPU-B REV. 2</b> <b>SCHEMATIC</b>		
DRAWN				
CHECKED				
		SCALE	SIZE	DRAWING NO.
			<b>B</b>	
DO NOT SCALE DRAWING			SHEET	

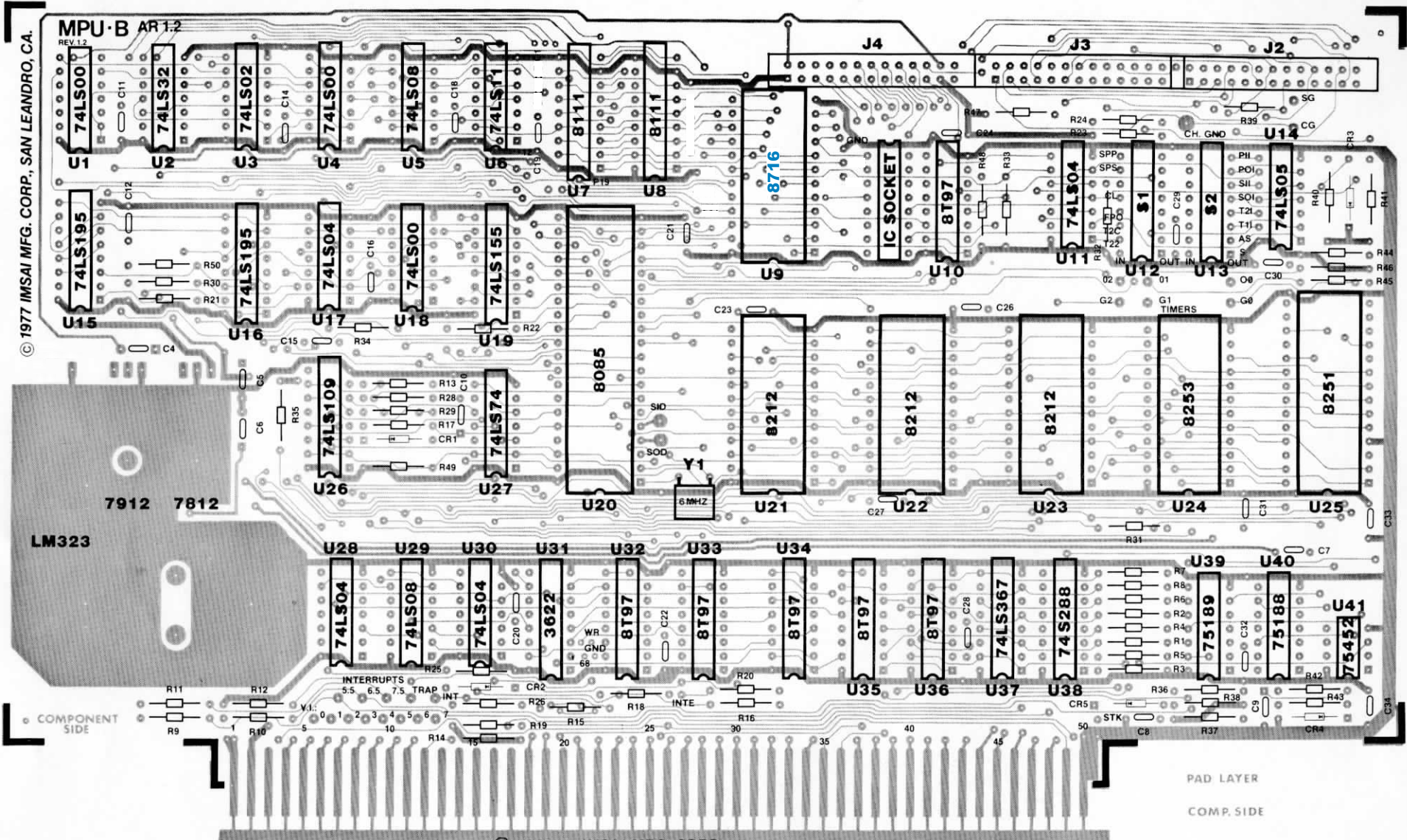

© 1977 IMSAI MFG. CORP.  
 SAN LEANDRO, CA.  
 ALL RIGHTS RESERVED WORLDWIDE  
 MADE IN U.S.A.

PAC 6-27-77

MPU-B IMSAI